



**NAPCO SECURITY TECHNOLOGIES, INC.**  
333 Bayview Avenue, Amityville, New York, U.S.A. 11701  
800-645-9445 (631) 842-9400 FAX (631) 842-9137  
*Note: Technical Service is for alarm professionals only*

# NAPCO Tech Support

## TECH TIP

**Date:** Thursday, May 30, 2024  
**Subject:** Resetting the Prima Super Panel  
**Models:** Prima Super Panel

If you need to reset your Prima Super Panel back to its factory default condition, proceed as follows, but be aware that resetting will completely remove all settings, sensors, devices, and monitoring settings.

1. At the Prima 'home' screen, tap the menu selection icon (at the top left).

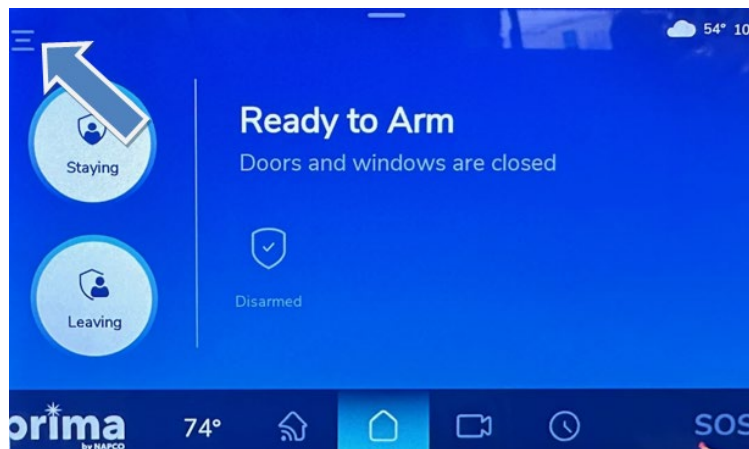

2. Enter the Master passcode:

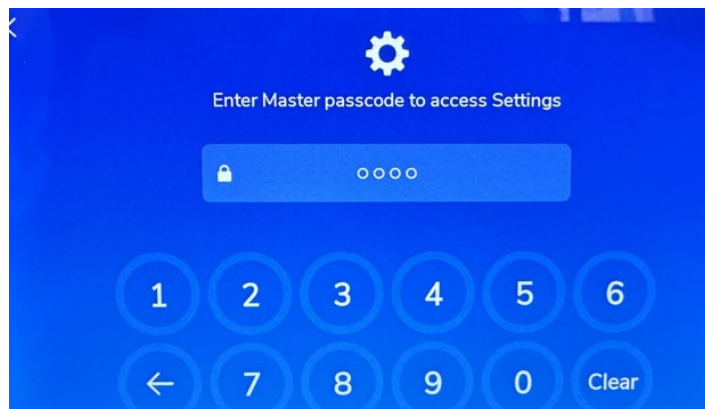



**NAPCO SECURITY TECHNOLOGIES, INC.**  
333 Bayview Avenue, Amityville, New York, U.S.A. 11701  
800-645-9445 (631) 842-9400 FAX (631) 842-9137  
*Note: Technical Service is for alarm professionals only*

3. In **Settings**, select **Security**.

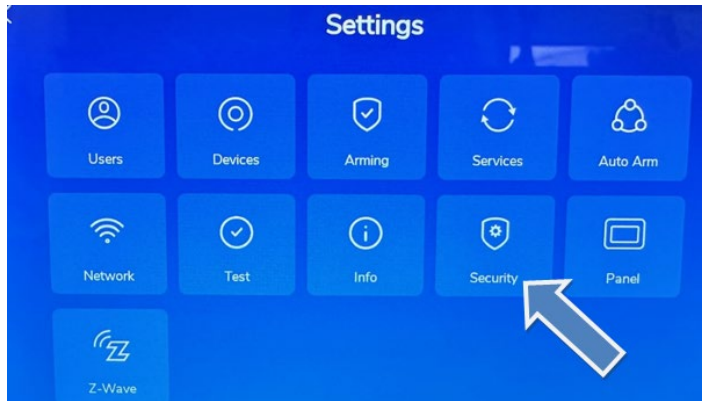

4. In **Advanced Security Settings**, scroll down and select **Factory Reset**.

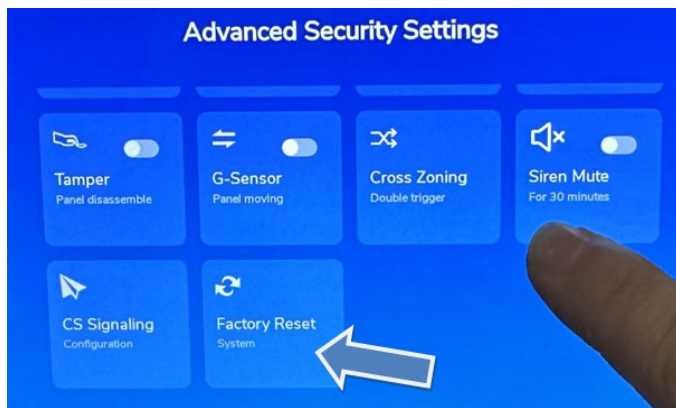

5. After reading the Warning popup that appears, and you are sure that you wish to continue, select **Factory Reset**.



The system will reset and will perform as if it was removed from its factory packaging and powered for the first time.