

Superterm-4: Four Door Intelligent Controller

CICP1400UL

Superterm-4 is an expandable intelligent controller which supports all access control functions for one to four doors. This distributed processor-based panel operates as a standalone unit in the event server-communications are interrupted. Superterm-4 is programmed via Continental's CardAccess3000® software, a Windows-based access control solution. Once programmed, our controller does not require continuous server communications, as it automatically stores system transactions in its internal memory. Superterm-4's memory is field expandable, allowing for greater cardholder populations and/or a larger transaction buffer. Flash EPROM firmware is easily upgraded when system enhancements are required. All of Continental's controllers feature extensive multi-stage lightning/transient protection for maximum reliability in harsh environments. Superterm-4 uses industry standard Wiegand output devices and supports virtually all card/reader technologies. Proximity, Biometric, Magnetic Stripe, Barcode, Wiegand, Barium Ferrite, Keypad and Smart Readers are easily connected and controlled. Superterm can store multiple card (bit) formats in its internal memory, making it a cost-effective retrofit panel. Supporting multiple bit formats allows existing card populations and readers to remain in place.

Up to 63 Controllers (Microterm, Miniterm, Smarterm, or Superterm) can be intermixed on the same communications network. Multiple communication networks (ports) can connect to our CardAccess® server for maximum system expansion. Controller communication choices include: hardwire (repeat or multi-drop mode), LAN/WAN, dial-up or fiber optics. Continental Access supports RS232, RS422 and RS485 communication formats for optimal system configuration.



Superterm-4 Capacities

- 20,000 cards standard (exp. to 145,000)
- 4 Five-wire, Wiegand output readers
- 4 Five-wire readers with 8 or 4 X-Y Matrix type keypads
- 4 Seven-wire X-Y Matrix type keypads
- 16 Supervised inputs
- 48 Additional inputs (Supervised)
- 9 Form C rated standard outputs at 3A@24VDC/VAC
- 48 Additional Form C rated outputs at 3A@24VDC/VAC
- 1000 Standard transaction buffer (exp. to 30,000)
- 128 Time schedules
- 1,000 Access groups
- 50 holidays
- APL Listed for FIPS compliance
- Capable of processing 256 bit cards from card to controller to software
- NVR/DVR integration
- Sophisticated Alarm Integration
- Reader Power 800mA@5VDC, 500mA@12VDC
- Battery Backup 4-6 hours included
- Enclosure Size 21.5"H x 21.25"W x 7"D, 48lbs.
- UL Listings UL294, UL1076, CE

**UL1950 replaced with EN60950 in Q2/2003

CICP1400UL: Four Door Intelligent Controller

Expansion Boards

Superterm-4 accepts up to 3 input/output expansion boards which can be preinstalled at our factory. The boards can also be ordered separately & field installed. Our boards are mounted to the inside of the hinged enclosure cover. The Alarm Expander Board provides 16 supervised inputs while the Relay Expander Board provides 16 relay outputs & 8 unsupervised inputs.

Power Supply

A standard on-board power supply provides 800mA @ 5VDC or 500mA @ 12VDC for reader power. An additional 3A @ 12VDC is available with the optional expanded power supply which includes a 12AH standby battery and upgrade to the standard 7AH battery. Superterm-4 can be ordered with an installed expanded power supply or ordered separately and field installed.

Typical Door Configuration

The Superterm-4 is UL Listed for UL294 (Access Control System Unit), UL1076 (Proprietary Burglar Alarm Unit) and UL1950** (Information Technology Equipment).

Typical Door Configuration

See Continental Access Configuration Guide for additional detailed system wiring information.

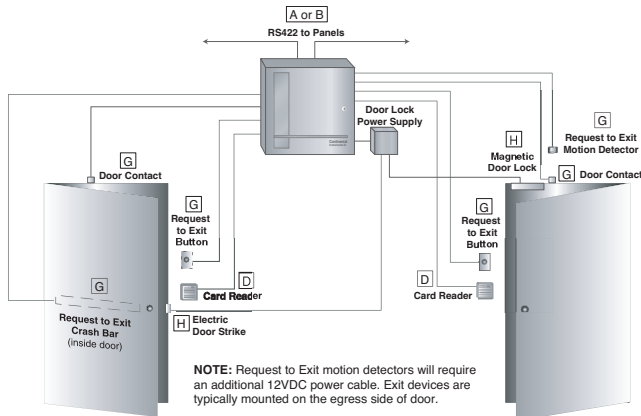

TURBO SUPERTERM-8 COMPONENTS		
QTY.	PART NO.	DESCRIPTION
1	CICP1800T or	EIGHT (8) READER CONTROLLER WITH STANDARD 40,000 CARD CAPACITY, 24 SUPERVISED ALARM INPUTS, TAMPER ALARM, AND 17 RELAY OUTPUTS. UNIT SHIPS COMPLETE IN A LOCKED STEEL ENCLOSURE INCLUDING A 7AH STANDBY BATTERY FOR MEMORY AND SYSTEM OPERATION.
	CICP1800TEXP	SAME AS ABOVE, WITH EXPANDED POWER SUPPLY. REQUIRED IF MORE THAN ONE RELAY EXPANDER BOARD (CICP1800TRB) IS USED OR ADDITIONAL 12VDC IS NEEDED. A 12AH BATTERY IS INCLUDED.
1	STANDARD	14VAC POWER SUPPLY VIA STEP-DOWN TRANSFORMER MOUNTED INSIDE ENCLOSURE. 10' POWER LINE CABLE WITH 110VAC PLUG IS INCLUDED.
1	STANDARD	7 AH BATTERY BACKUP INCLUDED.
1 OPTIONAL	CICEXPPWS	12V LINEAR EXPANDED POWER SUPPLY PROVIDES 3A @ 12VDC AUXILIARY POWER. 12AH BATTERY IS INCLUDED.
1 OPTIONAL	CICP1800MB2-1	MEMORY BOARD - 2MB (UP TO 145,000 CARDHOLDERS).
UP TO 3 OPTIONAL*	CICP1800RB	RELAY EXPANDER BOARD - 16 OUTPUT RELAYS, 8 ALARM INPUTS (UNSUPERVISED).
UP TO 3 OPTIONAL*	CICP1800AB	ALARM EXPANDER BOARD - 16 ALARM INPUTS (SUPERVISED). UL LISTED.
NOTE: *A MAXIMUM OF 3 EXPANSION BOARDS IN ANY COMBINATION MAY BE ADDED TO THE SUPERTERM ENCLOSURE.		

CICP1400 8-Door Intelligent Controller

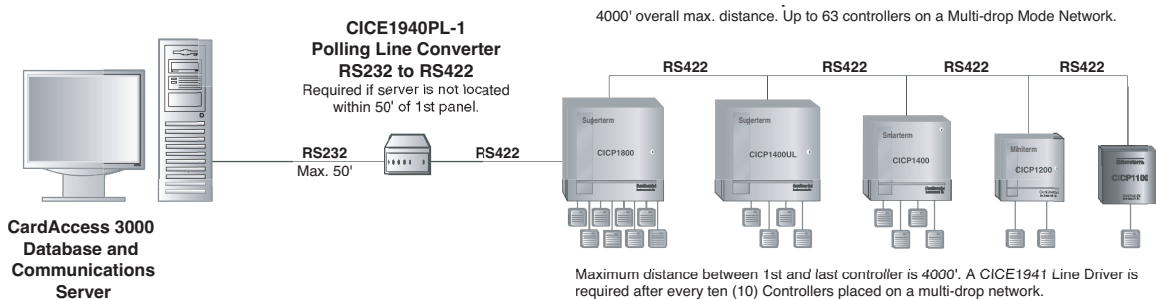

Continental Enterprise Controllers can connect to the server via hardwire (shown above), Ethernet LAN/WAN modem or fiber optics. See the Configuration Guide for additional detailed system information.

NAPCO ACCESS PRO, Continental Enterprise, Trilogy & Network are trademarks of NAPCO Security Technologies, Inc. Other marks remain intellectual property of their respect*Supports varying versions Continental Enterprise (Enterprise, CA4K, legacy CA3000, consult tech docs.)

